

GO SMOOTH LADY SHAVER



the beauty specialists

WARNINGS

- Please read all instructions thoroughly and retain for future reference.
- This appliance can be used by children aged 8 years and above and persons with reduced physical, sensory or mental capabilities or lack of experience and knowledge if they have been given supervision or instruction concerning the use of the appliance in a safe way and understand the hazards involved. Children shall not play with the appliance. Cleaning and maintenance shall not be made by children without supervision.
- For hygiene reasons we recommend for single person use only.
- Do not use on cuts or broken skin.
- Do not use this product on loose skinned parts of your body or any areas showing signs of: varicose veins, skin diseases (for example eczema, psoriasis, dermatitis), cuts and abrasions, irritation, warts, moles, hypersensitivity or sunburn, phlebitis, recent scar tissue, other skin conditions.
- Do NOT use this product if it is not working properly, or if it has been dropped or damaged.
- Keep out of reach from children and pets.
- This appliance must only be supplied at safety extra low voltage corresponding to the marking on the appliance.
- If the power lead or AC/DC adapter are damaged, it must be replaced by the manufacturer or its service agent or similarly qualified person in order to avoid a hazard.
- WARNING: Detach the supply cord before cleaning it in water.
- This appliance is for household use only.

KNOW YOUR UNIT

- | | |
|-----------------------------------|-------------------------------|
| 1 On/Off Button | 7 Trimmer |
| 2 Charging Indicator Light | 8 Floating Foil Shaver |
| 3 Rubber Seal | 9 Brush |
| 4 Micro USB Socket | 10 USB Charging Cable |
| 5 Cover | 11 Travel Pouch |
| 6 Shaver Head | |

CHARGING

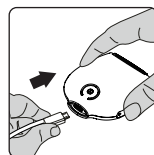

Open the Rubber Seal, insert the Charging Cable in to the Micro USB Socket and connect to a USB port.

The Charging Indicator Light will show red while charging. When fully charged the light will turn green.

Battery charging time: 2 hours.

Run time: 2 hours

NOTE: The unit cannot be used whilst charging.

GETTING STARTED



Ensure the skin is clean. The shaver can be used on wet or dry skin.
Remove the Cover.

To unlock and turn On, press On/Off for 3 seconds.

To turn Off press the On/Off button. To turn Off and lock the unit (useful when traveling) press and hold the On/Off button for 3 seconds.

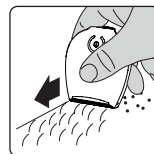

Apply a gentle pressure and move the Shaver Head over the skin.

The Floating Foil will follow the contours of your skin for an even and close shave, while the Trimmer blades target longer hairs to ensure smooth movement over the skin and to prevent scratches and nicks.

TIP: For best results, advance the Shaver Head against the direction of the hair growth.

CLEANING & MAINTENANCE

IMPORTANT: Do not use solvents or abrasive cleaners.

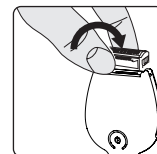

Ensure the shaver is turned Off and locked. Grip the Shaver Head and pull off.

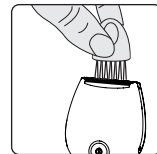

Use the Brush to remove any hair.

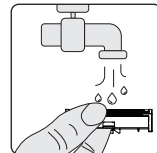

Rinse the Shaver Head with water and allow to dry.

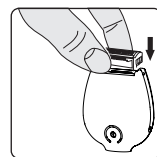

Press the Shaver Head firmly back into the unit.

SPECIFICATION

Model: SHSH
Input: 5V --- 350mA 1.75W
Battery: Li-Ion 3.7V 500mAh 1.85Wh
Charging time: 2 hours
Maximum run time: 2 hours



This product complies with current EU product legislation.



Direct current



Read these instructions carefully before use and then retain for future use.



This product is for indoor use only.

IPX4 splashproof

CUSTOMER CARE

If you have any questions, email us at: online@riobeauty.com

GUARANTEE

To register your two year guarantee online, visit:

www.riobeauty.com/pages/warranty-registration

DISPOSAL



The Waste of Electrical and Electronic Equipment (WEEE) Directive (2012/19/EU) has been put in place to recycle products using best available recovery and recycling techniques to minimise the impact on the environment, treat any hazardous substances and avoid the increasing landfill. This product is classed as Electrical or Electronic equipment so please ensure that at the end of the life of this product it is disposed of in the correct manner in accordance with local authority requirements. It must NOT be disposed of with household waste.

Recycle Responsibly:

1. Check your local municipal guidelines
2. Separate the components and dispose of them correctly

UK RP: The Dezac Group Ltd, PO Box 17, Cheltenham Spa, England GL53 7ET

EU RP: The Dezac Group (Europe) B.V. Azura,
Saturnusstraat 46-62, 2132 HB Hoofddorp, Netherlands

www.riobeauty.com

1-IN-SHSH-EU/1.0

